



THE CHARLES HOTEL
MUNICH
A ROCCO FORTE HOTEL

With large and flexible meeting rooms hosting up to 300 guests, The Charles Hotel is ideally located in the heart of Munich, overlooking the beautiful Old Botanical Garden with Historical Königsplatz, many museums and various art galleries within walking distance, it's a great base from which to explore the city.

Meetings & events

- Ballroom for up to 300 guests (dividable into 3 rooms) with separate entrance and 5m-high ceilings
- 7 conference rooms for up to 65 guests
- our 8th floor suites can be combined to form over 450m² of event space with private access, terrace and magnificent views
- Wi-Fi in public areas and all rooms

Accommodation

- 136 bedrooms
- 24 suites

Restaurants & bars

- *Sophia's* – restaurant and bar with terrace
- *The Library Lounge*

The Charles Spa

- Indoor pool (15m) in Munich - finish sauna and steam room
- 5 treatment rooms
- gym

Transfers

- 30 min drive from the international airport (MUC)
- 5 min walk from the central railway station (Hauptbahnhof)



The Charles Hotel

Sophienstrasse 28
80333 Munich Germany
T +49 89 544 555 1420
events.charles@roccofortehotels.com
roccofortehotels.com/the-charles-hotel

TheCharlesHotelMunich.RoccoForte

@RF_CharlesHotel

@thecharleshotelmunich



THE CHARLES HOTEL

MUNICH

A ROCCO FORTE HOTEL

	Size	Dimensions L x W x H	Boardroom	Cabaret	Classroom	Dinner	Reception	Theatre	U-Shape	Floor
Ballroom	300m ² 3229ft ²	23.16 x 13.26 x 5m 76' x 43'5" x 16'4"	–	108	120	180	300	220	–	Ground
Ballroom 1	100m ² 1076ft ²	7.7 x 13.26 x 5m 25'3" x 43'5" x 16'4"	22	36	40	60	95	80	24	Ground
Ballroom 2	100m ² 1076ft ²	7.7 x 13.26 x 5m 25'3" x 43'5" x 16'4"	22	36	40	60	95	80	24	Ground
Ballroom 3	100m ² 1076ft ²	7.7 x 13.26 x 5m 25'3" x 43'5" x 16'4"	22	36	40	60	95	80	24	Ground
Ballroom 1 & 2	200m ² 2152ft ²	15.44 x 13.26 x 5m 50'6" x 43'5" x 16'4"	–	72	72	120	185	150	42	Ground
Ballroom 2 & 3	200m ² 2152ft ²	15.44 x 13.26 x 5m 50'6" x 43'5" x 16'4"	–	72	72	120	185	150	42	Ground
Salon 1	60m ² 645ft ²	10.70 x 6.10 x 3m 35' x 20' x 9'8"	18	18	16	30	60	50	18	Ground
Salon 2	64m ² 688ft ²	11.50 x 6.10 x 3m 37'7" x 20' x 9'8"	18	18	16	30	60	50	18	First
Salon 3	74m ² 796ft ²	12.50 x 5.60 x 3m 41' x 18'4" x 9'8"	22	24	28	40	65	60	24	First
Salon 4	25m ² 269ft ²	5.20 x 4.76 x 3m 18' x 15'7" x 9'8"	8	–	–	–	–	–	–	First
Salon 5	25m ² 269ft ²	5.20 x 4.76 x 3m 18' x 15'7" x 9'8"	8	–	–	–	–	–	–	First
Salon 6	56m ² 602ft ²	8.60 x 7.13 x 3m 28'2" x 24' x 9'8"	12	12	12	30	40	40	12	First
Salon 7	56m ² 602ft ²	7.66 x 7.06 x 3m 25' x 23'2" x 9'8"	12	12	12	30	40	40	12	First
Salon 6 & 7	112m ² 1205ft ²	16.25 x 7.06 x 3m 53'4" x 23'2" x 9'8"	36	36	36	60	80	80	36	First

Event specialisation: car and product launches, incentives, executive meetings, roadshows, conferences

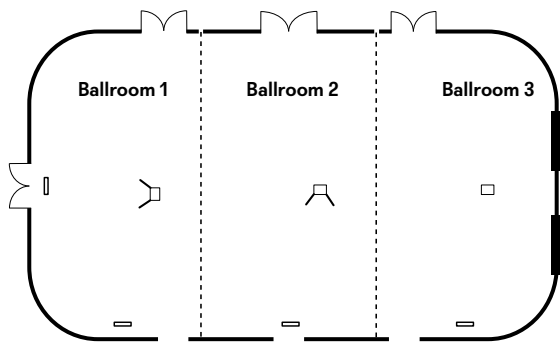

Ground Floor

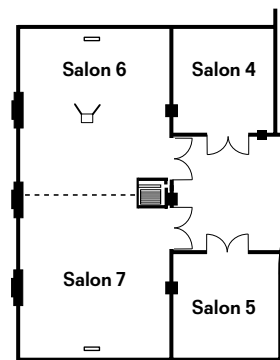

First Floor

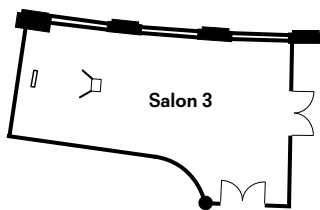

First Floor

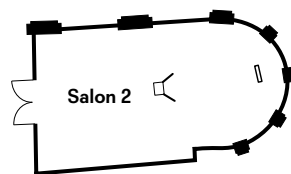

First Floor



Ground Floor