



BROWN'S HOTEL
LONDON
A ROCCO FORTE HOTEL

Meetings & events

- 6 meeting and event spaces for up to 70 guests in theatre style and 70 guests for a seated dinner
- *Historic Venue* – the Graham Bell Room was the site of the first telephone call
 - *Private Entrance* on Dover Street
 - *Bespoke Menus* by Adam Byatt upon request

Accommodation

- 98 bedrooms
- 17 suites

Restaurants & Bars

- *Charlie's*
- *The Drawing Room*
- *The Donovan Bar*

The Spa at Brown's

- 3 treatment rooms (incl. a double suite)
- 24h gym

Transfers

- 30 min drive from London City Airport (LCY)
- 45 min drive from London Heathrow Airport (LHR)
- 70 min drive from London Gatwick Airport (LGW)
- 10 min drive from Euston and Victoria Stations
- 15 min drive from St Pancras International and King's Cross Station
- nearest Underground: Green Park

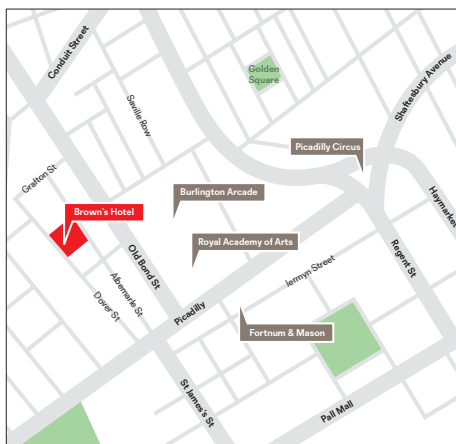

Brown's Hotel

Albemarle Street, London W1S 4BP, England
T +44 20 7493 6020
reservations.browns@roccofortehotels.com
roccofortehotels.com/browns-hotel

BrownsHotelLondon

@Browns_Hotel



BROWN'S HOTEL

LONDON

A ROCCO FORTE HOTEL

	Size	Dimensions L x W x H	Boardroom/ Hollow Square	Cabaret	Classroom	Banqueting Rounds	Reception	Theatre	U-Shape	Wedding Service with aisle
The Clarendon Room	76m ² 825ft ²	11.3 x 6.7 x 3.4m 37' x 22' x 11'	32/30	35	30	70	120	70	26	60
The Roosevelt Room	52m ² 568ft ²	7.6 x 6.8 x 3.8m 25' x 22'8" x 19'9"	18/18	18	18	40	60	40	16	50
The Niagara Room	50m ² 550ft ²	7.6 x 6.7 x 3.8m 24'10" x 22'2" x 12'9"	16/16	18	16	30	50	36	14	40
The Lord Byron Room	30.2m ² 328 ft ²	5.6 x 5.3 x 3.3m 18'8" x 17'6" x 11'	12	—	12	10	18	12	7	—
The Graham Bell Room	21.8m ² 234ft ²	5.1 x 4.2 x 3.3m 17' x 13'10" x 11'	8	—	8	8	14	12	—	12
The St George's Room	20.8m ² 224ft ²	5.5 x 3.8 x 3.4m 18' x 12'4" x 11'	8/8	—	8	6	14	12	—	—

View of Dover Street

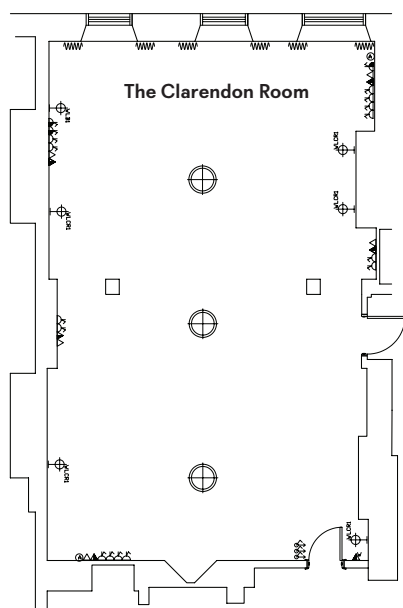

Ground Floor

View of Dover Street

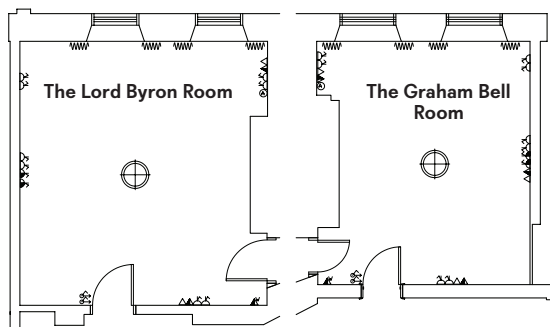

Ground Floor

View of Dover Street

View of Dover Street



Ground Floor

First Floor

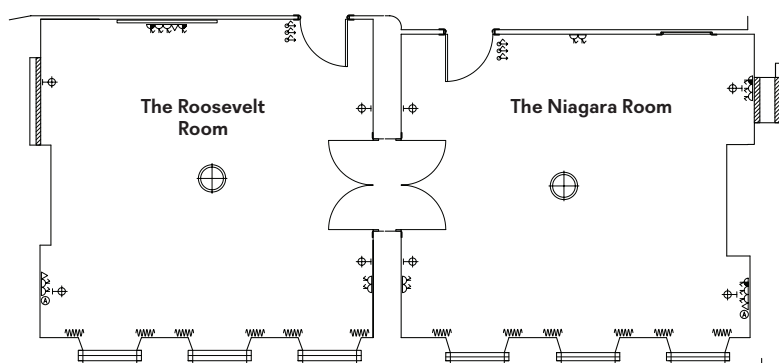

View of Albemarle Street