



BROWN'S HOTEL
LONDON
A ROCCO FORTE HOTEL

At Brown's Hotel, you'll feel a strong sense of London. Mayfair – and the city's most celebrated galleries, restaurants, parks and shopping streets. Tradition, cut with a spirited English humour and cosmopolitan twist: playful touches, modern artworks and a fresh, unfussy ease among the wood panels, smart suits and afternoon teas. The glamour and gaiety the iconic address deserves, and the quality and charm the Forte name assures.

Meetings & events facilities

- 6 meeting rooms (4 interconnect) for receptions of up to 120 guests
- all with natural daylight, sash windows and high ceilings
- business centre
- valet parking available

Accommodation

- 82 bedrooms from 30m²
- 33 suites from 50m²

Restaurants & bars

- *Charlie's*
- *The Drawing Room*
- *The Donovan Bar*

The Spa at Brown's

- 3 treatment rooms (incl. a double suite)
- 24-hour gym

Transfers

- 30 min drive from London City Airport
- 45 min drive from London Heathrow Airport
- 70 min drive from London Gatwick Airport
- 10 min drive from Euston and Victoria Stations
- 15 min drive from St Pancras International and King's Cross Station

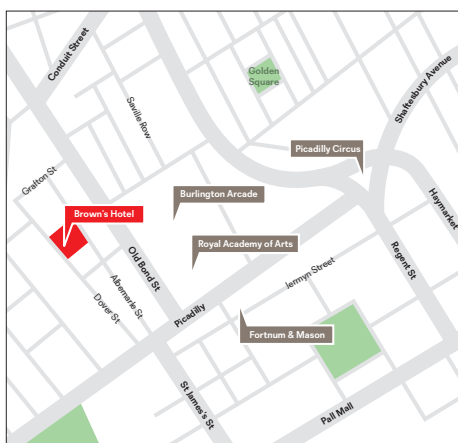

Brown's Hotel

Albemarle Street, London W1S 4BP, UK
T +44 20 7493 6020
reservations.browns@roccofortehotels.com
roccofortehotels.com/browns-hotel

BrownsHotelLondon
 @Browns_Hotel



BROWN'S HOTEL
LONDON
A ROCCO FORTE HOTEL

	Size	Dimensions L x W x H	Boardroom	Cabaret	Classroom	Dinner	Hollow Square	Reception	Theatre	U-Shape
The Clarendon Room	76m ² 825ft ²	11.3 x 6.7 x 3.4m 37' x 22' x 11'	30	30	30	70	30	120	70	30
The Roosevelt Room	52m ² 568ft ²	7.6 x 6.8 x 3.8m 25' x 22'8" x 19'9"	22	20	18	40	—	60	40	20
The Niagara Room	50m ² 550ft ²	7.6 x 6.7 x 3.8m 24'10" x 22'2" x 12'9"	22	20	18	40	—	60	40	20
The Lord Byron Room	30.2m ² 328 ft ²	5.6 x 5.3 x 3.3m 18'8" x 17'6" x 11'	14	—	12	12	—	16	10	
The Graham Bell Room	21.8m ² 234ft ²	5.1 x 4.2 x 3.3m 17' x 13'10" x 11'	8	—	8	10	—	14	8	
The St George's Room	20.8m ² 224ft ²	5.5 x 3.8m 18' x 12'4"	8	—	8	8	—	10	8	

View of Dover Street

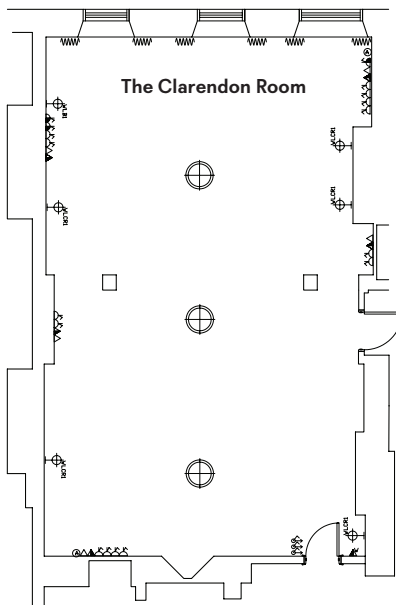

Ground Floor

View of Dover Street

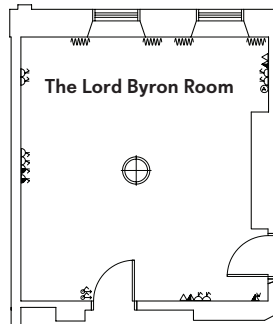

Ground Floor

View of Dover Street

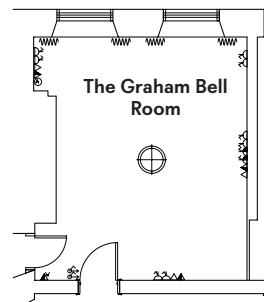

View of Dover Street

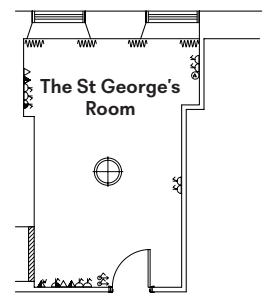

Ground Floor

First Floor

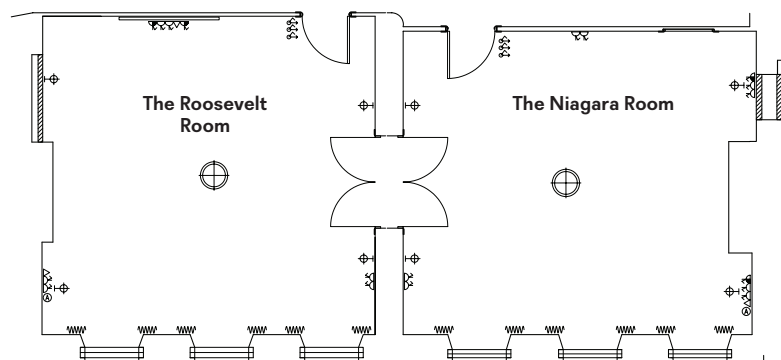

View of Albemarle Street